

10.1" HMI Bus Touch

TECHNICAL DETAILS

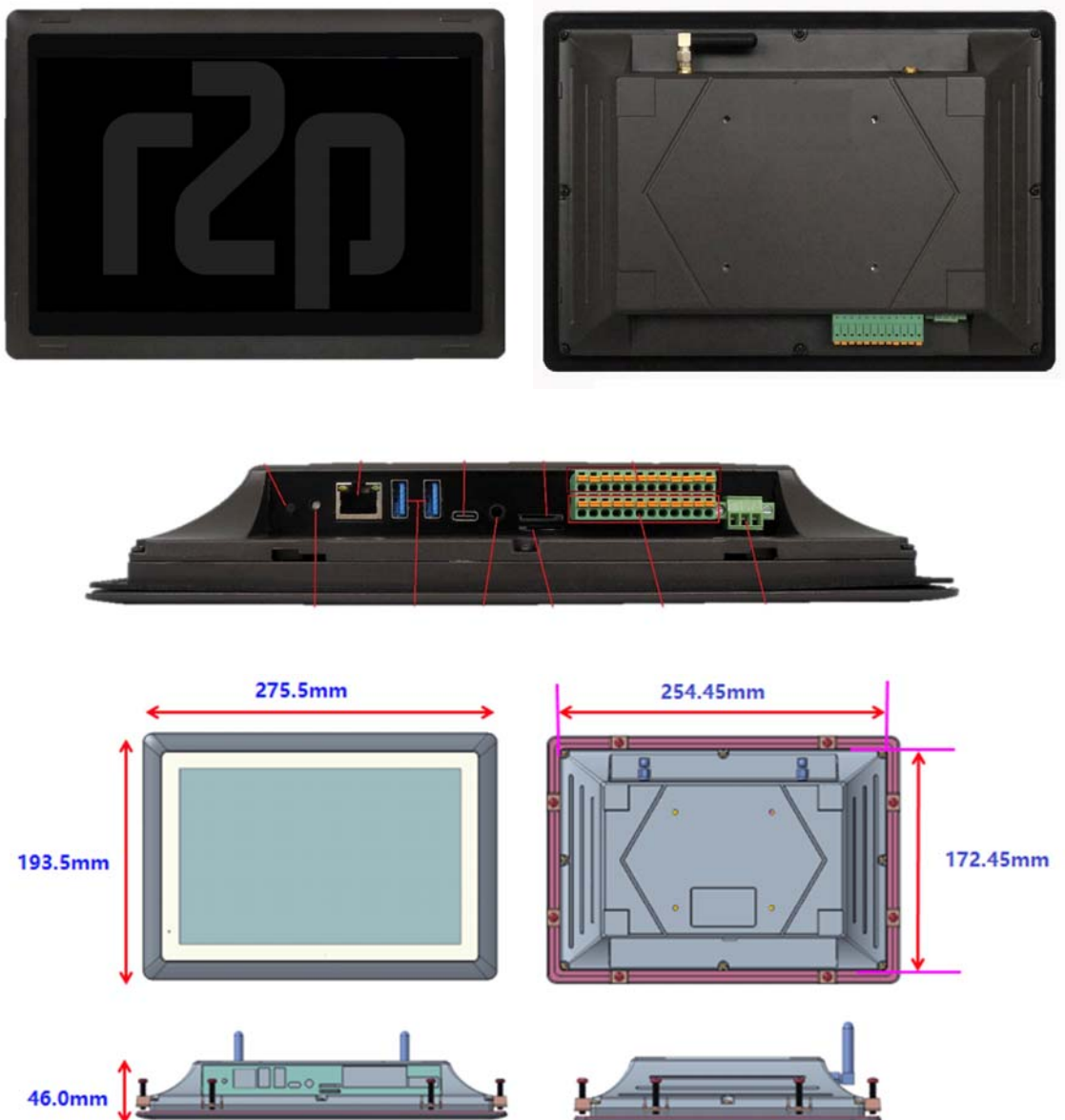

Product overview

The 10.1" HMI Bus Touch monitor is a high-quality industrial Panel PC. It features a 10.1" ten-point capacitive touch screen with a resolution of 1280 x 800 pixels and brightness of 400 cd/m².

The 10.1" HMI Bus Touch Panel PC is based around the powerful Raspberry Pi® Compute Module 4, powered by the Quad Cortex®-A72 processor with a processor speed of 1.5 GHz.

It runs a dedicated Linux based r2pOS that offers safe and secure remote update and configuration of both the OS itself as well as the applications running on the monitor.

Key features

FEATURE	DESCRIPTION
CPU	Raspberry Pi® CM4, Quad Cortex-A72 at 1.5 GHz
Display	10.1" IPS LCD, 1280 x 800 resolution, brightness 400 cd/m ²
Touch	10-point capacitive touch with 1 mm armoured glass
LAN	1 x Gigabit Ethernet, 1000BASE-T
Audio	3.5 mm audio out connector, 2 W internal speaker
3G/4G/LTE	Optional
Power Input	DC 12 V to 36 V
Current at 12 V	Maximum 800 mA
Power Consumption	Typical 9.6 W
Working Temperature	From 0 °C to +60 °C
OS	Linux based r2pOS
Dimensions	275.5 x 193.5 x 46.0 mm
Weight	1600 g

July 2022 / Rev. 1.00